



Fountain Park

Bolton, BL5 2AP

Asking price £459,950



Offered with no chain and situated on a quiet, executive development in a well-connected and leafy green location, this detached four-bedroom property has a stylish yet subtle contemporary Georgian design. It is a comprehensive family home with generous rooms throughout, providing convenience and practicality to meet the demands of modern family life.

A brief summary of the ground floor accommodation includes a spacious entrance hall with feature staircase, large living room, dining room, kitchen with island and breakfast seating, conservatory, utility room, downstairs WC and an attached double garage with internal access. To the first floor is an impressive gallery landing, four double bedrooms with two en-suites, a family bathroom, and a handy loft room accessed via one of the bedrooms.

Externally the house sits behind a large drive and walled front garden, while to the rear is a private, easy maintenance garden which gets plenty of sun from late morning through to the evening.



Living Space

The home welcomes you inside via the spacious entrance hall which gives the first impression of the generous proportions throughout.

To the left of the hallway past the feature staircase is the kitchen with central island and breakfast bar, which features a range of integrated appliances including a Range cooker with an electric double oven, six-ring gas hob and extractor, Neff microwave and dishwasher, and stainless-steel swan-neck mixer tap with sink set within the Brazilian granite worktop. The black worktop adds a stylish contrast to the traditional oak cabinetry, and there's a great amount of cupboard space plus an allocated spot for a large freestanding American-style fridge-freezer. Owing to the central island and breakfast bar this is also a great social spot when entertaining, while adding convenience and practicality for everyday life.

On the opposite side of the entrance hall the main living room is a great size, spanning the full depth of the house from front to back with natural light pouring in from both sides, giving a fresh, bright and airy feel. A chimney breast and contemporary fireplace with gas fire creates a traditional layout, while the French doors and floor to ceiling windows welcome you into the conservatory. There's also an air conditioning and heating unit in the conservatory.

Like all the other rooms the conservatory is a substantial size and offers that much needed versatility and extra living space for modern family life, and the French doors onto the garden provide a lovely indoor-outdoor lifestyle on warm summer days. Adjacent to the living room is a traditional dining room which also adds versatility in use and benefits from French doors onto the garden.

Practical Aspects

A door from the kitchen gives access to the utility which has plumbing for the washer/dryer and additional storage space, and leads further through to the double garage. The garage provides lots of space for storage and an extra loft space too. Off the central hall is also a downstairs WC and large storage closet for keeping coats, boots and other miscellaneous bits and bobs tidy and out of the way.

Bedrooms & Bathrooms

One of the standout features of this executive property is the spacious entrance hall and gallery landing. The large landing space connects the four bedrooms, all of which are large doubles ensuring there's plenty of space for the whole family.

The master bedroom boasts a large selection of fitted wardrobes and a three-piece shower en-suite with chrome heated towel rail and neutral tiling to the floor and walls. The second bedroom includes a three-piece shower en-suite too, and the third bedroom features a range of fitted furniture. The fourth bedroom is somewhat unique with it having a staircase up to a loft room, albeit there is a substantial amount of space and it would be a great room for a teenager! Or perhaps a home office, studio, or chillout space. The loft room has skylight windows with green views toward the neighbouring golf course. And within the family bathroom is a three-piece suite comprising a large jacuzzi bath, wash basin and WC.

Outside Space & Extension Potential

To the front of the house the large drive provides plenty of off-road parking, enough to accommodate four cars, and the garden to the rear is very private and easy maintenance, while providing scope for landscaping or a lawn if desired.

An added benefit of this property for those with the appetite for more space is to extend above the garage, creating what could be a further two bedrooms or an impressive master suite.

A Private & Peaceful Location

The location of this substantial family home is highly convenient yet private and peaceful too. The nearby centres of Westhoughton, Atherton and Hindley provide plenty of amenities within a short drive, from large supermarkets to independent shops, leisure facilities, cafes, pubs and restaurants, not to mention the wide variety of good schooling!

For those who frequently commute, there is easy access to junction 5 of the M61 via the A577, and Westhoughton and Daisy Hill railway stations are just a short drive away. Nearby green spaces include Cunningham Brook and Eatock Lodge which are both within walking distance - handy for walking four-legged friends. And Hart Common Golf Course is within a stone's throw.

Specifics

The tax band is F.

The tenure is Leasehold, though the Freehold is available to purchase for £1,800.

The ground rent is £50 per annum.

There are 900+ years remaining on the lease.

There is gas central heating with a Glowworm boiler located in the utility which we are advised has been serviced regularly.

Area Map



Floor Plans

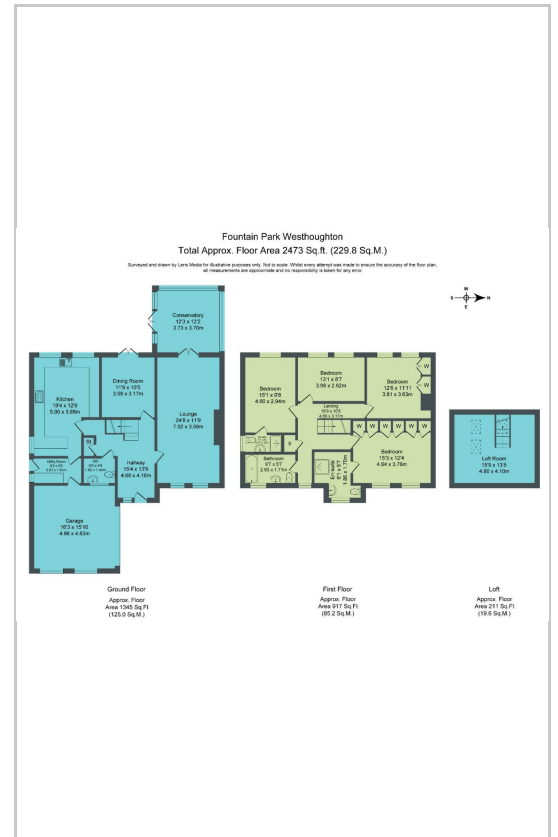

Energy Efficiency Graph

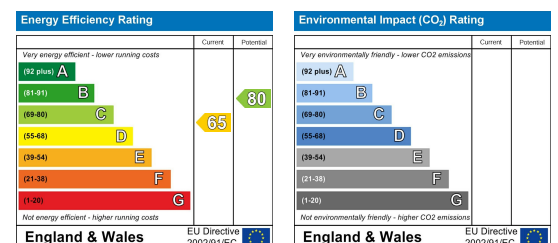

These particulars, whilst believed to be accurate are set out as a general outline only for guidance and do not constitute any part of an offer or contract. Intending purchasers should not rely on them as statements of representation of fact, but must satisfy themselves by inspection or otherwise as to their accuracy. No person in this firm's employment has the authority to make or give any representation or warranty in respect of the property.

Claves.

Claves House, 295D Darwen Road, Bromley Cross, BL7 9BT.

t. 01204 929 940 | e. info@claves.co.uk | w. claves.co.uk